

**This map denotes school policy between the hours of 8:15am - 9:00am and 3pm - 3:45pm, Mon to Fri during term time**

- Vehicles must **NOT** enter these areas, except by prior agreement with the school.
- Vehicles must **NOT** park in these areas.
- Vehicles **MUST** follow the direction of the arrows (one way system).

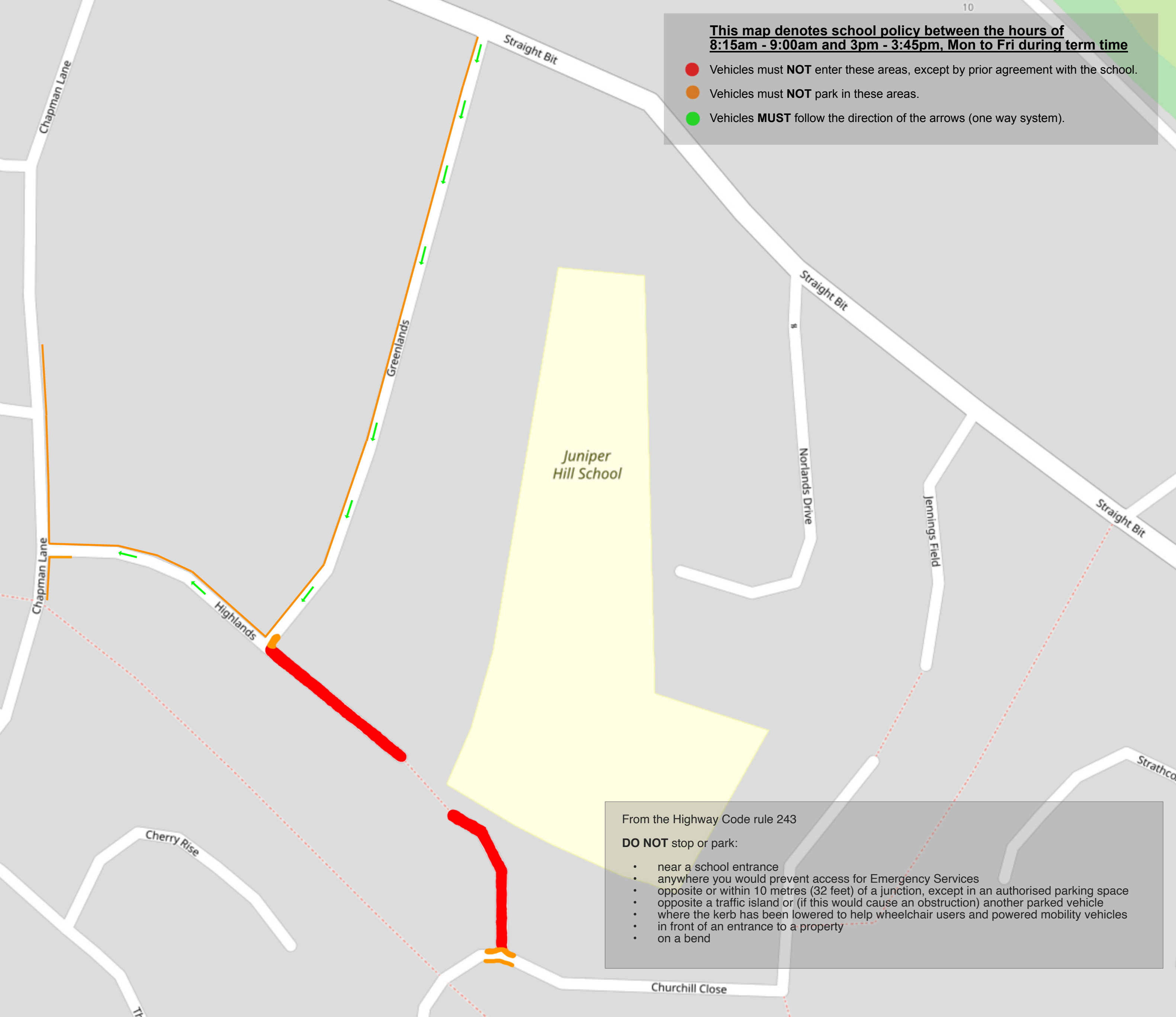

From the Highway Code rule 243

**DO NOT** stop or park:

- near a school entrance
- anywhere you would prevent access for Emergency Services
- opposite or within 10 metres (32 feet) of a junction, except in an authorised parking space
- opposite a traffic island or (if this would cause an obstruction) another parked vehicle
- where the kerb has been lowered to help wheelchair users and powered mobility vehicles
- in front of an entrance to a property
- on a bend